



PRV Series DIRECT ACTING PRESSURE REDUCING VALVES

For irrigation

The **BERMAD PRV Series** Direct Acting Pressure Reducing Valves have been specially designed for use where accurate and reliable control of line pressure is required, regardless of fluctuations in supply pressure and/or flow rate.

FEATURES

- The use of a rolling diaphragm provides:
 - Complete separation of the mechanism from the flow, resulting in long, trouble-free service.
 - Minimum friction resistance to mechanism movement, resulting in accurate performance.
- PRV regulators are available with a wide range of spring selection, for downstream pressure setting.
- PRV regulators are available in two models: adjustable and fixed downstream preset pressure.
- PRV regulators are also available in drip-tight models for static pressure conditions.



1 1/2"

1"

3/4"



Model 150-PRV

Specifications

Sizes: 1 1/2"

End Connections: BSP, NPT
Female-female threading

Flow Capacity Range:
0.45-18.2 m³/h

Pressure Rating:
Minimum working pressure
0.7 bar (10 psi)
maximum working pressure
9 bar (130 psi)

Temperature Range:
Water up to 80°C (180°F)

Materials:

Body: Brass
Seals: Buna-N and NR
Diaphragm: Nylon-fabric,
reinforced Buna-N
Spring and shafts: Stainless steel

Standard Feature:
Drip-tight sealing

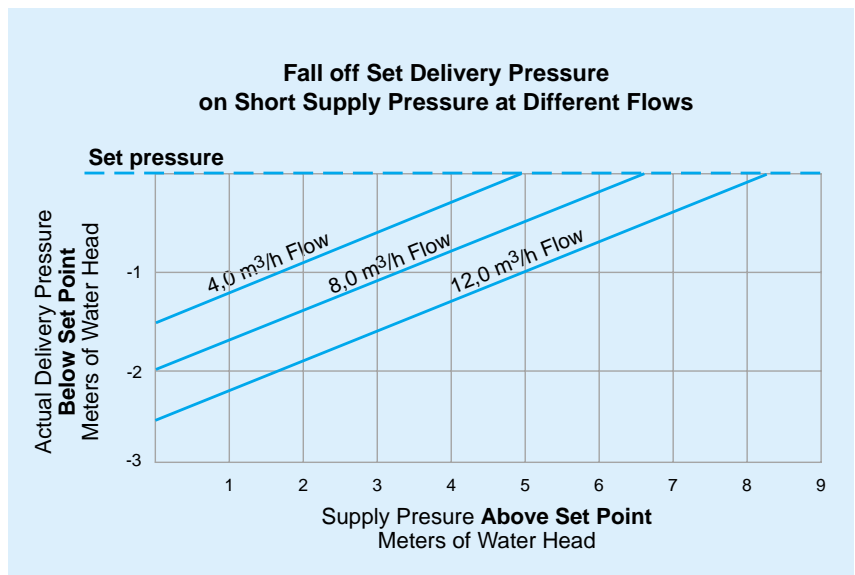

Dimensions and Weight

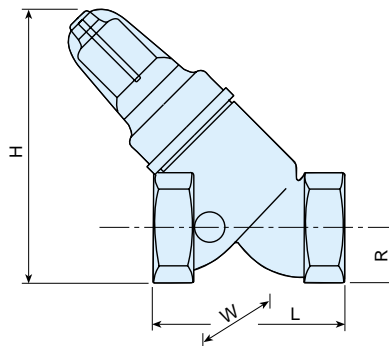

Size (mm)	1 1/2"
L	106
H	155
W	65
R	30
Weight (kg)	1.0

Spring Selection Diagram

